

SIGNATURE DUAL LINK KIT

Installation and User Guide



Contents

1.	Explanations of Symbols	2
2.	Installation and Commissioning	3
3.	General Information	11
4.	Guarantee	13
5.	Opera Warranty Terms and Conditions	13

1. Explanations of Symbols



Read information with this symbol carefully and urgently follow instructions. This information is safety-relevant.



This product must be disposed of in a separate refuse collection in the European Union. Do not dispose of as normal domestic waste.



Read Instructions



This symbol indicates hazards due to electrical voltage. There is mortal danger!

2. Installation and Commissioning

2.1 Contents

(A) Receiver x 1



(B) Controller x 1



(C) Y Splitter Cable x 1



(D) Cable Clip x 4



(E) Actuator to Receiver Cable x 1



(F) Cable Connection Cover x 3



(G) Bed Bolt x 2



(H) Bed Washer x 4



(I) Bed Nut x 2





Before you begin! Read this Installation Guide conscientiously before installing the Signature Dual Link Kit.

1. Unpack the Contents

Unpack the contents of the Signature Dual Link Kit and place to one side.

If the beds have side skirts, remove the skirts from the inner side of each bed where they will be joined together. Refer to the Signature Profiling Bed Installation Guide on how to do this and the below step.

Unbrake the castors of the Signature Profiling Beds and position the two beds parallel to one another, with at least two meters between them. Brake the castors once positioned.

Using the bed handset, electronically adjust the backrest of the beds to gain access to the control boxes, this is where the link kit will be connected in the next steps.



Only unbrake the castors when the beds need moving to prevent rolling away and injury. Turn off all power to the bed(s) after adjusting.

Signature Bed



Two Parallel Signature Beds



Signature Bed with Back and Leg Rest Raised

2. Connect the Y Splitter Cable

Unplug the power cable of the bed (1) from the short power supply cable (2) next to the control box (as per photos below).

Connect the two pronged plug of the Y splitter cable (3) to the power cable (1).

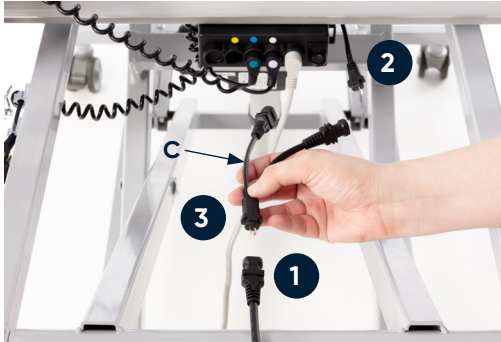

Connect the socket on the splitter cable (4) to the two pronged head of the short power supply cable (2).

Take a connection cover (F) and push the joined cables (the plug and socket) into the cover, this should cover where the two cables connect.

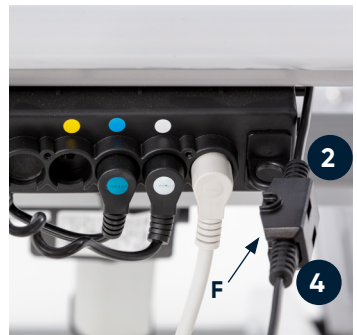

3. Connect the Actuator to Receiver Cable

On the actuator to receiver cable (E), take the two pronged head (6) and connect it to the remaining socket on the Y splitter cable (C).

Place the joined cable into a connection cover (F).

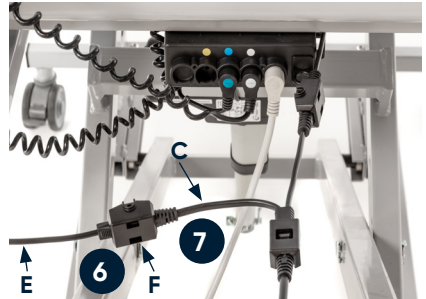

4. Connect the Receiver

On the actuator to receiver cable (E), take the round plug socket (8) and connect it to the plug (9) on the receiver (A).



5. Connect the Actuator

Unplug the height adjustment actuator cable from the control box, this is the actuator plug that is colour coded with a yellow sticker (both on the control box and on the plug).

Connect the receiver to actuator cable (E) socket (10) to the two pronged plug of the height adjustment actuator cable (11).



6. Secure the Actuator Cable

Take two cable clips (D) and remove the self adhesive backing paper.

Attach the two cable clips on the chassis towards the control box and near the backrest actuator (see below).

Attach these approx. 3.5cm apart. Pull open the cable clips and attach the actuator cable as per the diagram below. Press the edge of the clips down to lock.



7. Secure the Receiver

Take two cable clips (D) and attach them to the inside of the mattress platform side channel, this needs to be at the side where the two beds will be joined together. Place the cable clips approx. 5cm apart and approx. 13cm from the chassis securing bolt (12).

With one hand pull open the security clip and push the cable into the clip, repeat this step for the second clip.

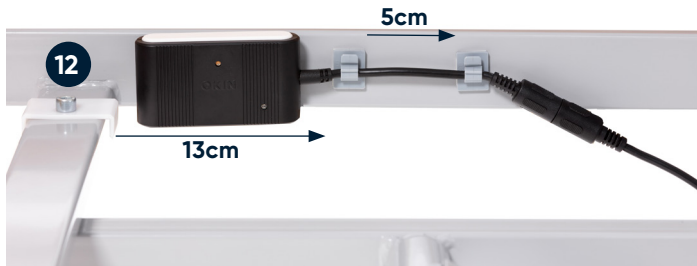

8. Sync up the Receiver and Controller

Turn on the power to the bed. The receiver (A) light should turn on and the LED on receiver should turn yellow.

Insert the supplied batteries into the controller (B).

Press the pairing button (see photo below) on the receiver twice, the LED should turn blue. You now have 10 seconds to pair the controller.

Press the up and down buttons of the controller simultaneously until the LED on the receiver starts blinking. The blinking confirms successful pairing.

To confirm successful pairing, use the controller (see photos below) to raise and lower the bed by pressing the up and down buttons.

The distance between the receiver and controller should be no less than two meters during synchronisation.

(A) Top of Receiver



(A) Side of Receiver

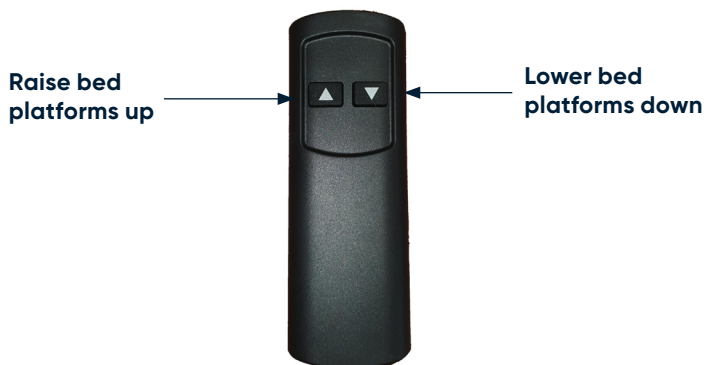
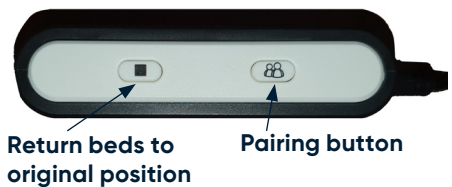

(B) Controller

9. Connect the Second Bed

On the second bed, unplug the height adjustment actuator cable from the control box. This is the actuator colour coded with a yellow sticker.

Take the actuator to receiver cable (E) and connect it to the height adjustment actuator, make sure that the long actuator to receiver cable is under the mattress platform and out of the way of any moving parts.

Check that the second bed is connected to the receiver by raising and then lowering the bed with the controller, both beds should simultaneously raise and lower together.

10. Attach the Beds Together

Unbrake the castors on the beds and push the two frames together so that they are flush.

Place one of the Bed Attachment Bolts (G) and Washer (H) into holes A on the side of the bed frames. Once the bolt is through both bed frames, attach the Bed Nut (I) and Washer (H) with a wrench. Repeat this process with hole B.



Once secured, unbrake the castors of both beds and move the bed to ensure that the bolts are adequately tightened. If there is any movement between the frames re-tighten the bolts.



Attention: Use both of the supplied bolts to ensure that the beds are secured together. Always brake the castors after the beds have been repositioned.

3. General Information

3.1 Intended Use

The Signature Dual Link Kit may only be used under the conditions described in this instruction manual. The Signature Dual Link Kit is designed to be used together with the Signature Dual Profiling Beds so that the bed platforms can be raised together, simultaneously.

3.2 Not Intended Use

All uses deviating from the intended uses will be classed as non-intended. This will void the warranty terms and conditions. Non-intended uses include:

- Using the Signature Dual Link Kit for a use not outlined in this instruction manual.
- Modifying the Signature Dual Link Kit.

3.3 Warnings



Before installing the Signature Dual Link Kit, it is recommended that the Signature Dual Beds do not have anything attached or on them, this includes; grab rails, side rails and mattresses.



During the briefing, specific attention must be drawn to any potential dangers for the first time, the instruction manual must be read conscientiously and in detail by the user/care personnel.

Any incidents or issues must be reported to Opera at, support@operabeds.com.



Always brake the castors of the beds when the bed is in use, only unbrake the castors when the beds need moving. Failing to observe this warning may result in the bed rolling away and injury.



Only adults should operate and use the Signature Dual Link Kit, including the controller.



Do not lower or raise the beds without the consent of both occupants, failing to observe this warning may result in entrapment and injury.



Read the Signature Profiling Bed Installation Guide and Technical Specifications V2, before installing the Signature Dual Link Kit and operating the beds. Failure to do so may result in serious injury, entrapment and electric shock.

When operating the adjustment functions of the bed, ensure that the cables do not get caught or pulled out.

3.4 Service Life and Disposal



The service life is dependent upon the manner of use. The Signature Dual Link Kit must not be disposed of as normal household waste after the end of its service life. Contact your local waste recycling facility for further instructions.

3.5 Specifications

Specification Data	
Controller	2.4 GHz radio bidirectional controller
Bluetooth®	Built-in
Power supply	29 V DC
Housing colour	Black and White
Protection degree	IP20
Relative air humidity	30% to 75%
Ambient temperature	10°C to 40°C

4. Guarantee

As stated in the Standard Terms and Conditions, below, Opera provides a manufacturer's warranty of 1 year from the date of purchase.

5. Opera Warranty Terms and Conditions

5.1 Warranty Terms

5.1.1 Subject to the terms and conditions set out below, Opera agrees to repair or replace the product within the United Kingdom at its own cost, and any Opera accessory supplied with it, purchased by you from Opera. In circumstances where the product does not perform in accordance with Opera's specifications during the warranty period of 1 year, commencing on the date of delivery (or deemed delivery) of the product.

5.1.2 This contractual product warranty does not operate to limit rights under the statutory warranties referred to in clause 5.3.1 below.

5.2 Warranty Conditions

5.2.1 Proof of purchase (invoice) must be provided when requesting service under warranty.

5.2.2 Opera requires any customer requesting service under the warranty to comply with directions from Opera staff in relation to troubleshooting any issue and facilitating any repair or replacement under these Warranty Terms and Conditions.

5.2.3 The customer is responsible for inspecting all goods received from Opera upon arrival. In instances where goods have been damaged in transit, the customer must report this to Opera within 3 working days of receipt of the product. Failure to report physical damage on arrival within three working days of receipt may result in denial of warranty for physical damage.

5.2.4 Opera reserves the right to replace the product or relevant part with the same or equivalent product or part, rather than repair it. Where a replacement is provided, Opera will determine, in its discretion, the closest product within the current range of products offered by Opera with which to replace the faulty or damaged product. The replacement product may differ with the replaced product in size and specifications, at the reasonable election of Opera. Opera may replace parts with refurbished parts. Replacement of the product or a part under the warranty does not extend or restart the warranty period.

5.2.5 If Opera is unable to repair or replace the product, the customer will be provided with credit for Opera products or may be refunded the price of the product (at Operas election). This credit or refund will be for the amount of the purchase price of the product, excluding the associated delivery cost.

5.2.6 In the event that a replacement, refund, or store credit is provided as per section 5.2.5, the faulty item will become the property of Opera.

5.2.7 Opera may seek reimbursement of any costs incurred by you where the product is found to be in good working order.

5.2.8 Opera reserves reasonable discretion to determine whether any product is or is not performing in accordance with Opera specifications, subject to applicable law.

5.3 General

5.3.1 Legislation may imply warranties or conditions or imposes obligations on Opera, which cannot be excluded, restricted or modified in relation to consumer goods.

5.3.2 To the full extent permitted by law, but subject always to clause 5.3.1, the warranty will not apply in respect of a product:

(a) If the product has not been installed, operated, maintained or used in accordance with the Opera instructions or specifications provided with the product;

(b) If the factory-applied serial number has been altered or removed from the product;

(c) To damage, malfunction or failure resulting from alteration, accident, misuse, abuse, fire, liquid spillage, mis-adjustment of customer controls, use on an incorrect voltage, power surges and dips, thunderstorm activity, force majeure, voltage supply problems, tampering or unauthorised repairs by an persons, use of defective or incompatible accessories, exposure to abnormally corrosive conditions or entry by any insect, vermin or foreign object in the product.

(d) To damage arising during transportation, installation or while moving the product or to any transportation costs of the product or any parts thereof to and from the customer, unless otherwise specified in these warranty terms and conditions;

(e) To any third-party software or hardware not contained in the product as originally configured by Opera.

(f) To any failure, to the extent that the failure is not a failure of the product to perform in accordance with its specifications.

(g) To service of any product whilst it is outside the United Kingdom.

5.3.3 To the full extent permitted by law, but subject always to clause 5.3.1:

(a) Opera will not be liable for any loss, damage or alterations to third party products, no matter how occurring; or for any loss or damage arising from loss of use, loss of profits or revenue, or for any resulting indirect or consequential loss of damage.

(b) Opera's aggregate liability in respect of all claims under the warranty shall not exceed the original purchase price of the product or, at Opera's option, the replacement of the product with a like or similar product.

(c) Opera excludes all other warranties, conditions, terms, representations and undertakings whether express or implied.

Notes

Notes

Notes



Azure House, Connaught Road, Kingswood, Hull, HU7 3AP

0333 222 8584 | support@operabeds.com | operabeds.com

Version 2 | Published in July 2022